

PLAN
OF
SOUTHERN GROUP
OF
RUINED BUILDINGS,
DANDĀN-UILIQ.

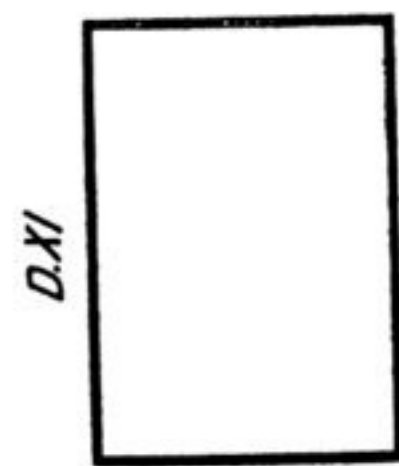

⌘



⌘

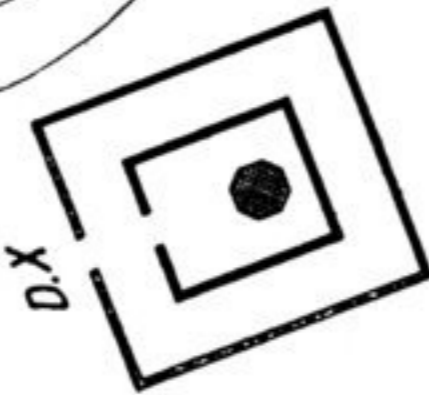
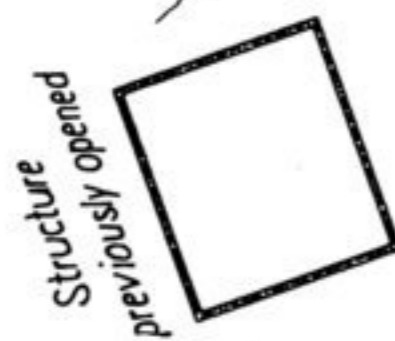

Sand-dune
16'

Ancient fruit trees

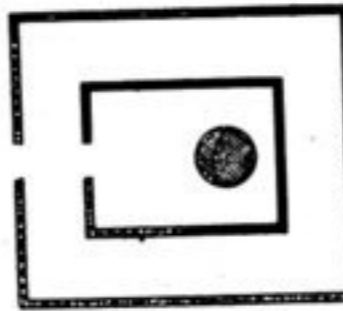

Sand-dune
8'

Ancient fruit trees

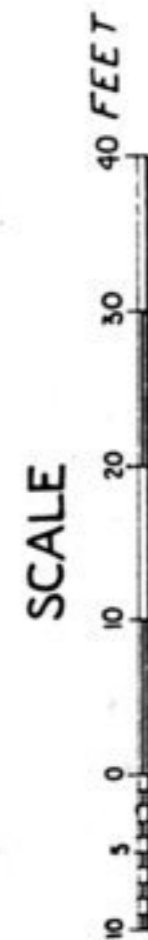
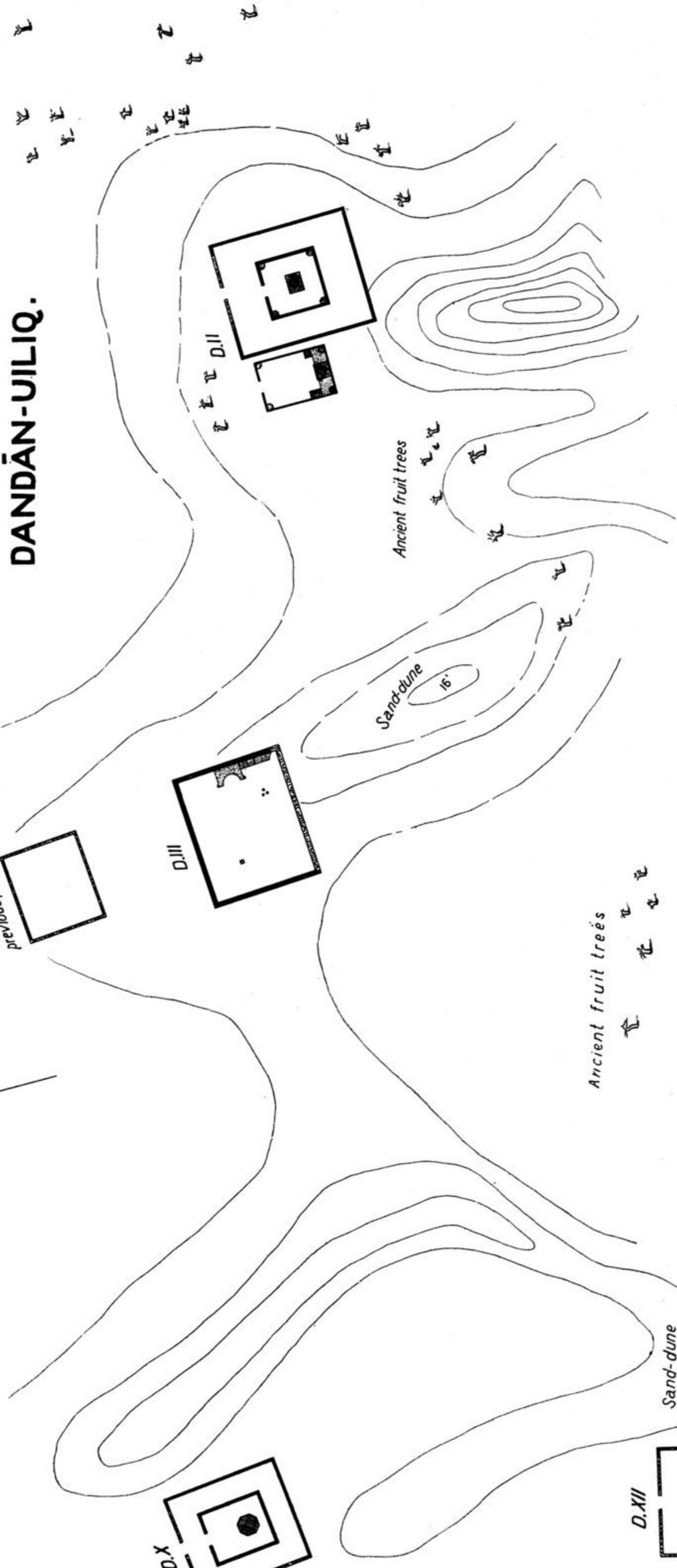
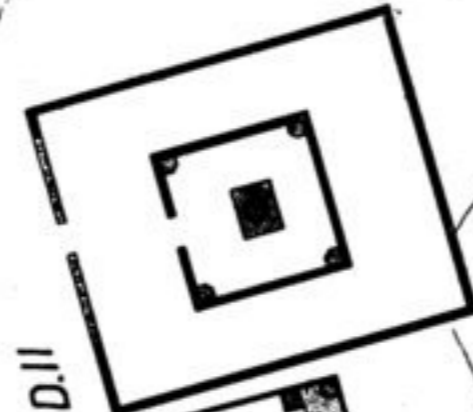

- Wall of timber and plaster.....
- ditto ruined.....
- Raised platform (fireplace).....
- Statue base of plaster.....
- Wooden board.....
- Ancient garden tree.....

M. A. STEIN & RAM SINGH DEL